





148a Rochdale Road, Firgrove, Rochdale, OL16 3DA

£199,950

🛏 2 🚿 1 🛋 2



- No Chain
- Two Bedrooms
- Brand New Bathroom
- Great Location
- Semi Detached
- Brand New Kitchen
- Brand New Flooring
- EPC: D





NO CHAIN. Offered for sale is this lovely two bedroom semi-detached property located between Milnrow and Rochdale. This gorgeous home has been renovated to offer brand new fittings internally, including the kitchen, bathroom and flooring throughout. Accommodation comprising: Lounge, dining room and a good size kitchen. To the first floor there are two bedrooms and a lovely brand new bathroom. Externally there is a good size rear garden, lawn to the front plus an allocated parking space. There are also visitor spaces as well. Local shops and amenities within easy reach as are motorway networks.

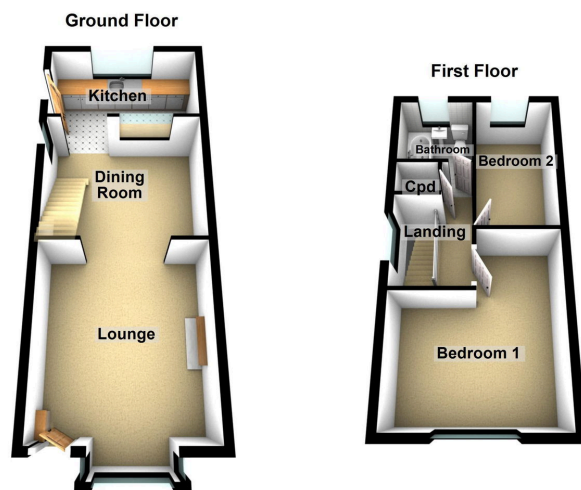

#### Chadderton Office

509 Middleton Road,  
Chadderton, Oldham,  
OL9 9SH

chadderton@kirkham-property.co.uk  
t: 0161 626 5688