



Shaw Hall Bank Road, Greenfield, Saddleworth

£200,000

🛏 2 🍳 1 🚿 1



- Turn key stone terrace
- Two bedrooms
- Shaker style fitted kitchen
- Upgraded electrics & heating
- Outlook towards Dovestones
- Five minute walk to Greenfield Railway Station
- Village conveniences nearby
- Energy rating D





Located in a popular Greenfield location is this turn key condition mid terrace. This stunningly presented two bedroom home will appeal to first time buyers and downsizers alike due to the impressive level of finish found throughout the home.

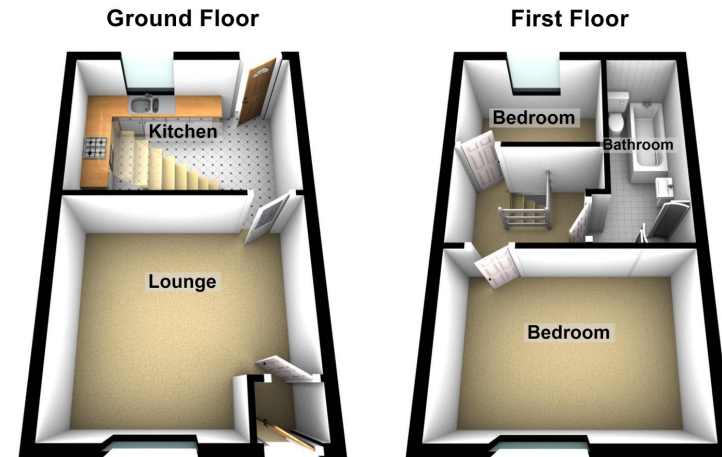

Total area: approx. 52.7 sq. metres (566.8 sq. feet)

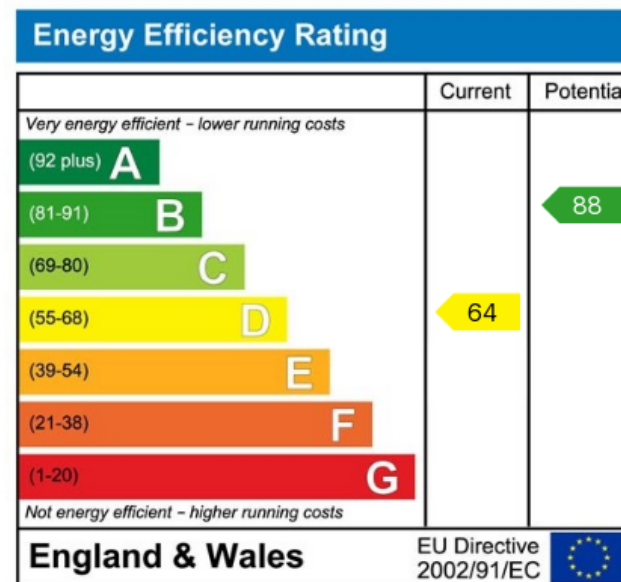

Uppermill Office

35 High Street
Uppermill,
Saddleworth
OL3 6HS

Monday – Friday. 9am – 5pm
Saturday. 10am – 3 pm
uppermill@kirkham-property.co.uk
t: 01457 810 076
f: 01457 810 222

Out of hours telephone service
Monday – Thursday 8:30am – 7pm
Friday – 8:30am – 5pm
Saturday – Sunday 10am – 3pm

www.kirkham-property.co.uk