



Grains Road, Delph, Saddleworth

£365,000

🛏 3 🚿 2 🛋 2



- Spacious stone property
- Three double bedrooms
- Two reception rooms
- Country style shaker kitchen with Range cooker
- End of terrace
- Stunning views towards Castleshaw
- Easy to tend rear garden
- Energy rating TBC





Positioned on the fringes of Delph village is this well appointed, stone end of terrace. A spacious home over four floors offering three double bedrooms along with two reception spaces. The current owners have continually upkept the property to present a walk-in condition property for the prospective purchaser. Superior uninterrupted views reach from Denshaw through Delph towards Castleshaw.

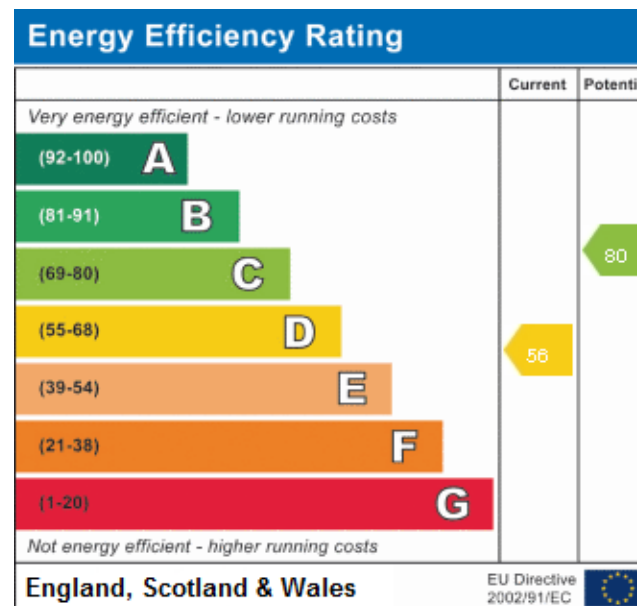
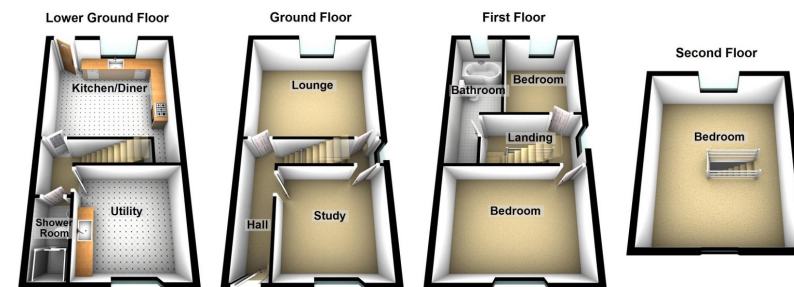

Uppermill Office

35 High Street
Uppermill,
Saddleworth
OL3 6HS

Monday – Friday. 9am – 5pm
Saturday. 10am – 3 pm
uppermill@kirkham-property.co.uk
t: 01457 810 076
f: 01457 810 222

Out of hours telephone service
Monday – Thursday 8:30am – 7pm
Friday – 8:30am – 5pm
Saturday – Sunday 10am – 3pm