

## 10 Locking Gate Rise

Offers Over £225,000

3 1 1



- Detached Family Home
- Lovely Handless Fitted Kitchen/Dining Room
- Four Piece Bathroom
- South Facing Rear Garden
- Three Bedrooms
- Elevated Location
- Excellent Condition Throughout
- EPC: C

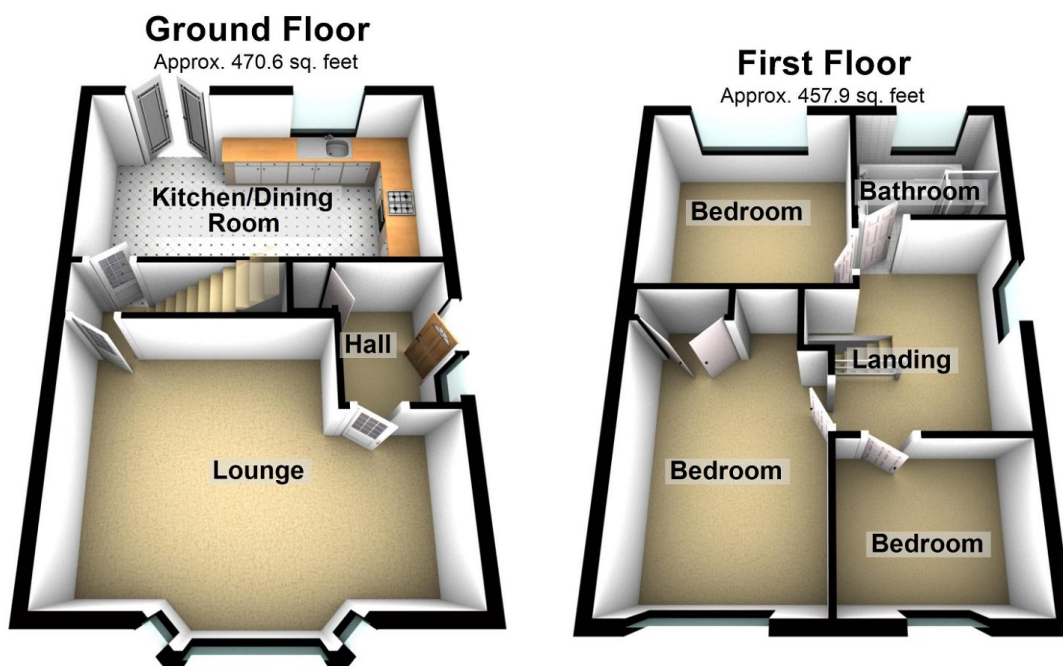

Total area: approx. 928.6 sq. feet

WOW !! Yes it is detached so don't hang around, get booked in to view this one. Offered for sale is this delightful three bedroom detached family home located in Waterhead. Accommodation comprising: Entrance hallway, lounge and a large kitchen/dining room. To the first floor are three bedrooms and a four piece bathroom. Externally there is a south facing rear garden and a good size driveway to the front. Schools within easy reach as are motorway networks. Call us today to arrange an appointment to view this lovely home.