



Turf Park Road, Royton

Offers In Region Of £170,000

3 1 1

- True Bungalow
- Two Reception Rooms
- Great Location
- Open To Offers
- Three Bedrooms
- In Need Of Modernisation
- Close To Royton Center
- EPC: D



NO CHAIN. Offered for sale is this three bedroom semi detached true bungalow in need of updating. Located in this popular spot close to Shaw and Royton and local bus routes. Plenty of scope for improvement. Accommodation comprising: Entrance hallway, large lounge/dining area, kitchen, two double bedrooms and a single bedroom, bathroom. Externally there is a rear garden, garage and driveway parking. Call us today to arrange a viewing.



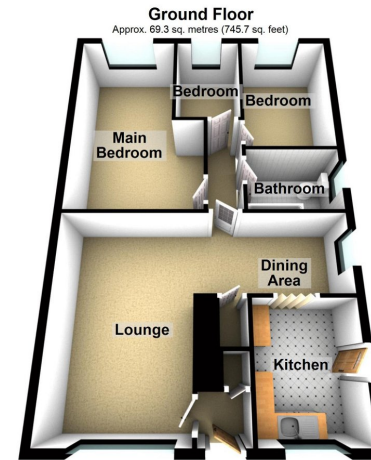

Total area: approx. 69.3 sq. metres (745.7 sq. feet)



Score	Energy rating	Current	Potential
92+	A		
81-91	B		84 B
69-80	C		
55-68	D	56 D	
39-54	E		
21-38	F		
1-20	G		

Chadderton Office

509 Middleton Road,
Chadderton, Oldham,
OL9 9SH

chadderton@kirkham-property.co.uk
t: 0161 626 5688