



Edgemoor Close, Watersheddings

£250,000

🛏️ 4 🚿 2 🛋️ 2



- Extended Semi-Detached
- Four Bedrooms
- Spacious and Versatile Family Home
- Cul-de-Sac Location
- Well presented Throughout
- Must Be Viewed
- EPC - tbc



Situated in a quiet cul-de-sac location is this spacious versatile home ideal for the young and growing family. In a sought after location the property is very well presented throughout and must be viewed to appreciate the size of the accommodation on offer. With good size rooms throughout the property comprises of porch, lounge, modern kitchen/diner with an excellent range of wall and base units, downstairs bedroom and large wet room whilst to the first floor there are a further three bedrooms (master with fitted wardrobes and En-suite shower) and a modern family bathroom. Externally there are gardens to both the front and rear and a driveway providing ample off road parking. This property really is the perfect family home!

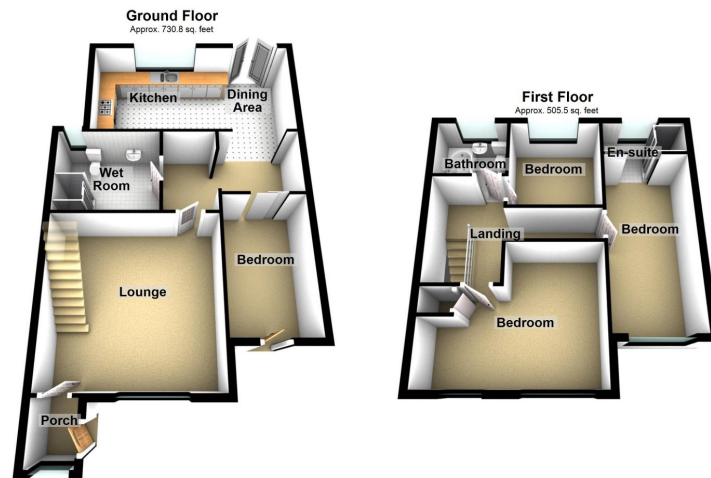

Total area: approx. 1236.4 sq. feet

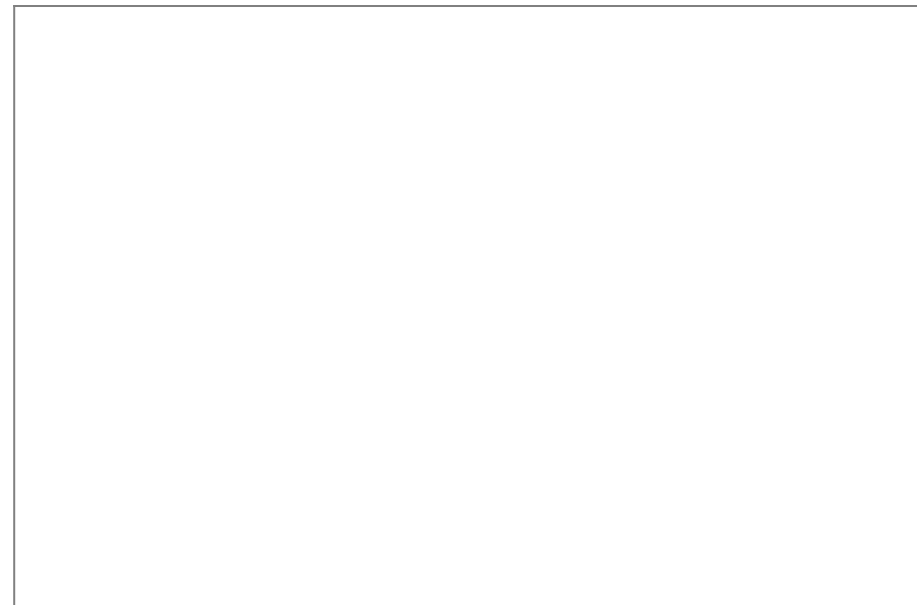

Chadderton Office

509 Middleton Road,
Chadderton, Oldham,
OL9 9SH

chadderton@kirkham-property.co.uk
t: 0161 626 5688