



Lawton Square, Delph, Saddleworth

£258,000

3 1 1



- Traditional Weavers Cottage • Three Bedrooms
- Modern Bathroom With Underfloor Heating • Off Road Parking For One Car
- Spacious Lounge With Multi-Fuel Stove • Over Three Floors
- Central Village Location • Energy Rating D



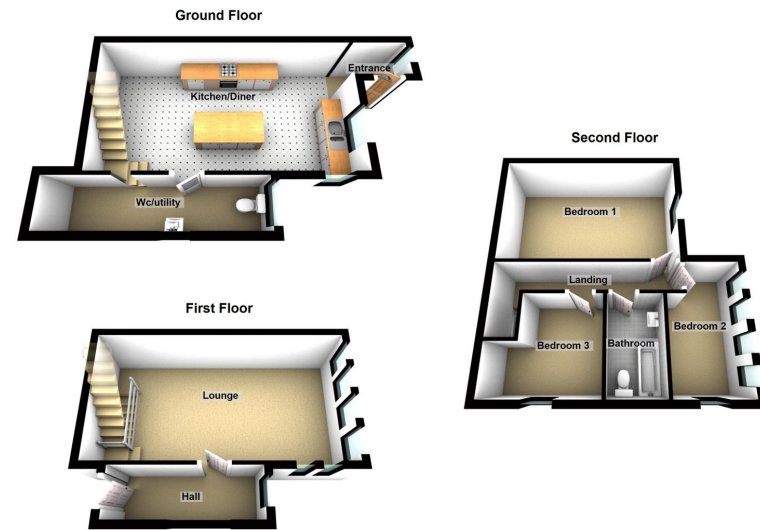

Situated in the heart of the Saddleworth village of Delph is this three bedroom, three storey weavers cottage. Wonderful character charm is found internally including Mullion windows and exposed roof beams along with a contemporary finish. Off street parking is provided by a driveway space along with a low maintenance courtyard area.

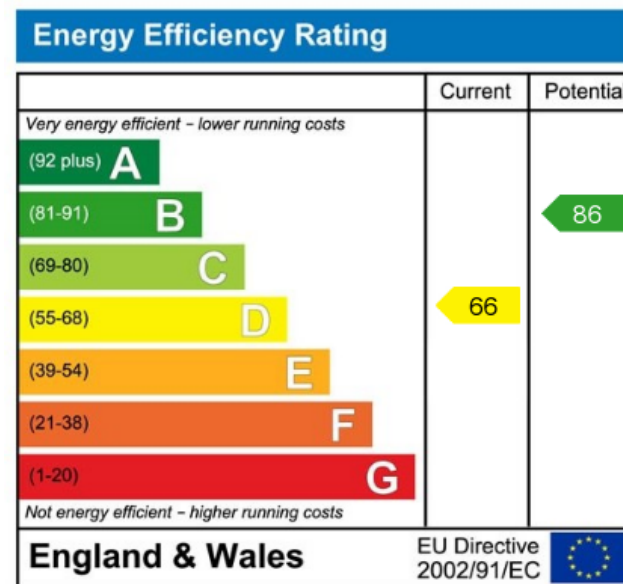

Uppermill Office

35 High Street
Uppermill,
Saddleworth
OL3 6HS

Monday – Friday. 9am – 5pm
Saturday. 10am – 3 pm
uppermill@kirkham-property.co.uk
t: 01457 810 076
f: 01457 810 222

Out of hours telephone service
Monday – Thursday 8:30am – 7pm
Friday – 8:30am – 5pm
Saturday – Sunday 10am – 3pm