





## Seville Street, Shaw

£149,950

🛏 2 🚿 1 🛋 2



- Two Bedroom Mid Terraced Home
- Loft Room
- Superb Condition Throughout
- Two Reception Rooms
- South Facing Rear Garden
- Short Walk To Shaw Center
- Hallway, Rear Porch
- EPC: TBC

Offered for sale is this lovely two bedroom mid terraced property is in close proximity of Shaw centre. In wonderful condition throughout, viewing is essential. Accommodation comprising; Entrance hallway, lounge, dining room, kitchen and a rear porch. To the first floor are two bedrooms, bathroom and a loft room with staircase. Externally a south facing rear garden and on road parking.

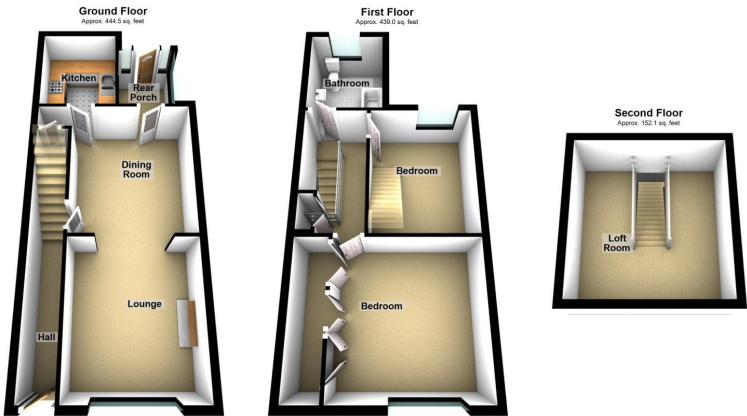

Total area: approx. 1035.5 sq. feet

| Score | Energy rating | Current | Potential |
|-------|---------------|---------|-----------|
| 92+   | A             |         |           |
| 81-91 | B             |         |           |
| 69-80 | C             |         | 78 C      |
| 55-68 | D             | 59 D    |           |
| 39-54 | E             |         |           |
| 21-38 | F             |         |           |
| 1-20  | G             |         |           |

Chadderton Office  
509 Middleton Road,  
Chadderton, Oldham,  
OL9 9SH

chadderton@kirkham-property.co.uk  
t: 0161 626 5688