



Turf Pit Lane, Moorside

£144,995

🛏 2 🚿 1 🚺 1



- Built in 1850
- Wonderful Condition
- New Roof in 2022
- South Facing Yard
- Character Stone Cottage
- Recently Fitted Kitchen
- New Boiler And Radiators in 2022
- EPC: TBC

WOW ! This one is lovely, i would definitely get your shoes on to go and view this one ! On offer is this wonderful mid terraced cottage offered in lovely condition throughout, move straight in. Accommodation comprising; Entrance vestibule, lounge, kitchen/dining room. To the first floor are two bedrooms and a fitted bathroom. Externally is a due south facing rear yard and on road parking. This property is sat on the cusp of Saddleworth and beautiful surrounding areas with amazing walks over local farmland. Call us today to arrange a viewing.

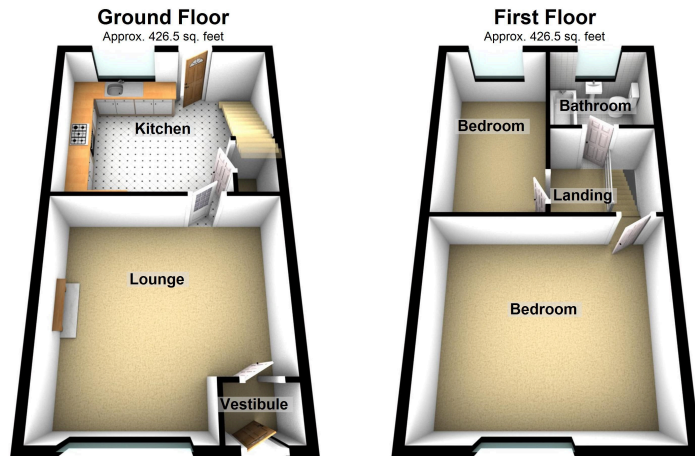

Royton Office
64 Rochdale Road,
Royton, Oldham,
OL2 6QJ

Monday – Friday. 9am – 5pm
Saturday. 10am – 3 pm
royton@kirkham-property.co.uk
t: 0161 626 9789
f: 0161 652 0514

Out of hours telephone service
Monday – Thursday 8:30am – 7pm
Friday – 8:30am – 5pm
Saturday – Sunday 10am – 3pm

www.kirkham-property.co.uk