





# High Street, Uppermill, Saddleworth

£280,000

3 2 1





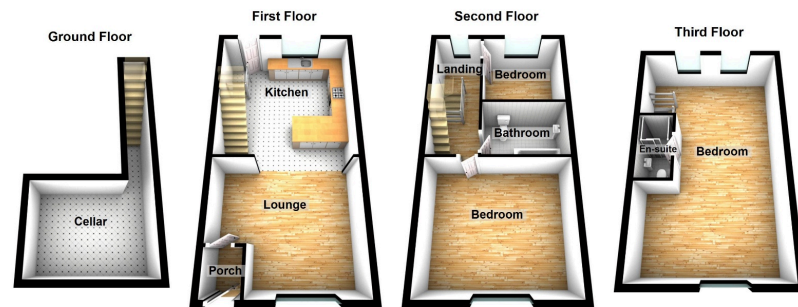

Situated within the heart of Uppermill village is this three bedroom stone terrace property on High Street. Just a few minutes walk to all your amenities and benefitting from off road parking to the rear. This property is being sold with no onward chain with generous room sizes throughout.

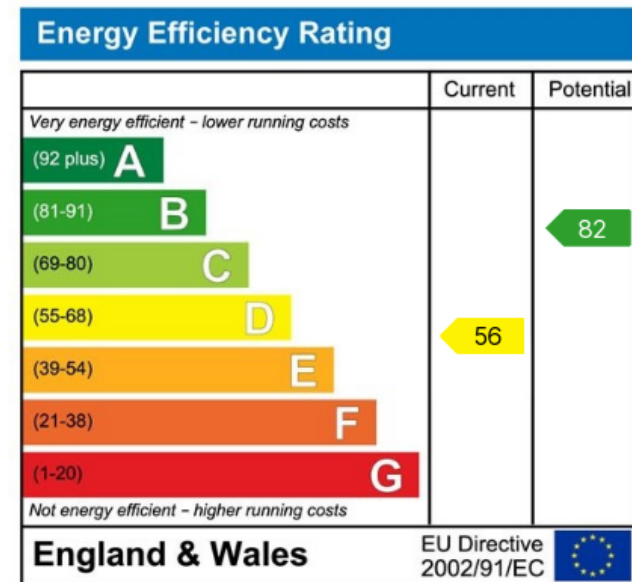

### Uppermill Office

35 High Street  
Uppermill,  
Saddleworth  
OL3 6HS

Monday – Friday. 9am – 5pm  
Saturday. 10am – 3 pm  
uppermill@kirkham-property.co.uk  
t: 01457 810 076  
f: 01457 810 222

Out of hours telephone service  
Monday – Thursday 8:30am – 7pm  
Friday – 8:30am – 5pm  
Saturday – Sunday 10am – 3pm

[www.kirkham-property.co.uk](http://www.kirkham-property.co.uk)