

## Williams Cresecent, Chadderton, Oldham

£165,000

3 1 1



- Semi - Detached House
- En-suite To Master Bedroom
- Lawned Gardens
- Gas Central Heating
- 
- Three Bedrooms
- Garage & Driveway
- uPVC Double Glazing
- EPC Rating -
- 

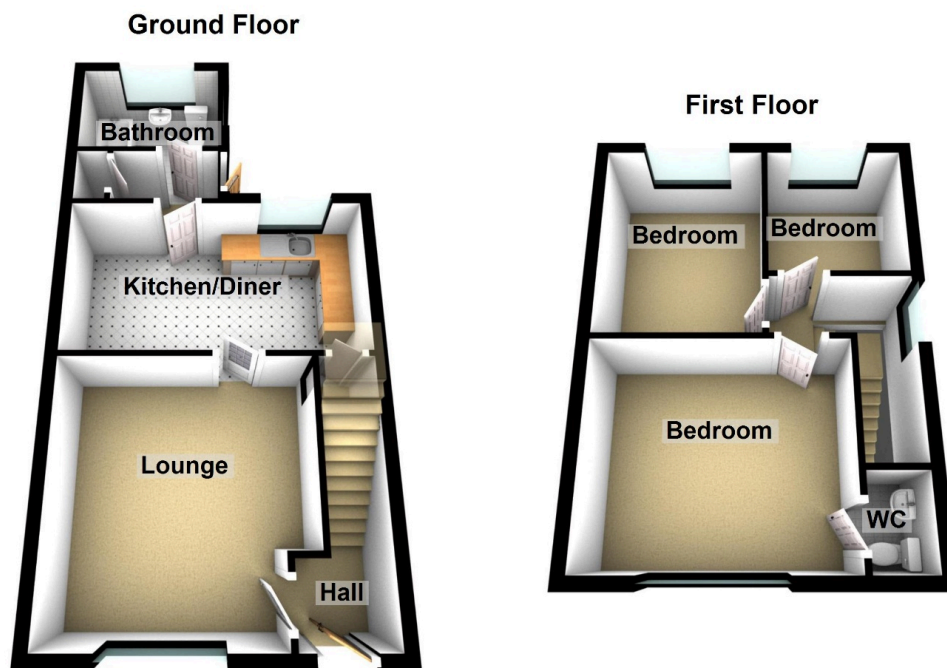

No Chain - Offered for sale is this extended, semi-detached house situated in a popular and convenient location in South Chadderton and within reach of all local amenities and the M60 motorway connections. Although in need of a degree of modernisation the property offers the potential of being a good size family home. The property benefits from uPVC double glazing throughout and gas central heating and briefly comprises of: entrance hallway, lounge, kitchen/

diner, bathroom and three bedrooms (master with en-suite WC). Externally there are gardens to both the front and rear with a driveway leading to a single detached garage.