

Cavalier Square, Chadderton, Oldham

£380,000

🛏️ 4 🚿 3 🚗 1



- Executive, Detached, Family Home
- Modern Fitted Kitchen/Diner
- Two Useful Store Rooms
- Driveway Parking
- Four Double Bedrooms, Three Fitted & Master En-Suite
- Separate Utility Room
- Gardens To Front & Rear
- EPC Rating - B

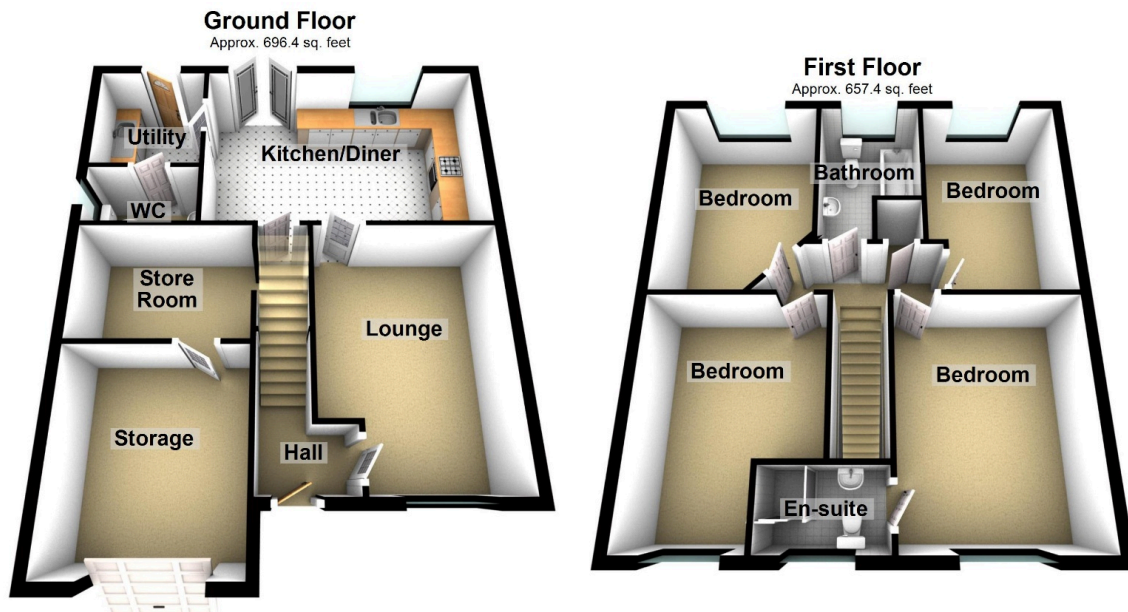

Total area: approx. 1353.8 sq. feet

If you are looking for an executive, detached, family home that is ready to move into; then this could be the property for you. Beautifully presented throughout, this four double bedrooomed, detached property must be viewed to fully appreciate the quality and size of accommodation on offer. Situated in a popular location close to excellent local schools, local amenities and only a short drive to the North West motorway connections. The property briefly comprises of: entrance hallway, lounge, kitchen/diner, utility room, downstairs w.c., two useful storage areas and to the first floor four double bedrooms, three fitted and the master en-suite and a family bathroom. Externally there is a driveway providing off road parking to the front and to the rear an enclosed garden with lawn and patio areas. The property benefits from uPVC double glazing and gas central heating.