





# Bleasdale Street, Royton, Oldham

£285,000

3 1 0



- Detached Family Home
- Three Bedrooms
- Driveway Parking & Integral Garage
- Modern Fitted Breakfast Kitchen
- Beautifully Presented Throughout
- South Facing Rear Garden
- Conservatory
- EPC Rating -

A beautifully presented, extended, three bedroom, detached family home located in this tucked away cul-de-sac in Royton. Built by 'Maunder's Homes' in 1991 this lovely property offers superb accommodation comprising of: entrance porch, cloakroom/w.c., lounge, dining room, kitchen/breakfast room, conservatory, integral garage, three good size bedrooms( all with fitted furniture) and a lovely shower room. Externally a wonderful South facing rear garden with reaching views and front driveway parking for two cars. Local schools within easy reach.

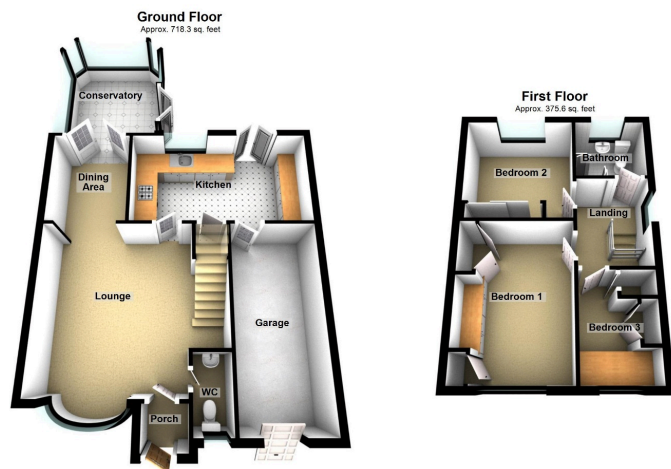

Total area: approx. 1093.9 sq. feet

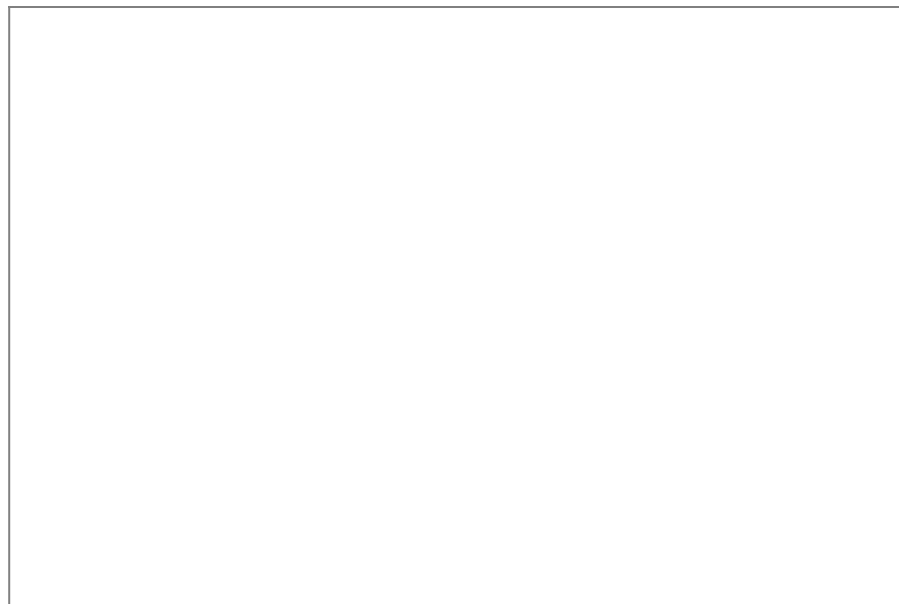

Royton Office  
64 Rochdale Road,  
Royton, Oldham,  
OL2 6QJ

Monday – Friday. 9am – 5pm  
Saturday. 10am – 3 pm  
royton@kirkham-property.co.uk  
t: 0161 626 9789  
f: 0161 652 0514

Out of hours telephone service  
Monday – Thursday 8:30am – 7pm  
Friday – 8:30am – 5pm  
Saturday – Sunday 10am – 3pm