



Ashleigh Close, Royton

£270,000

🛏️ 3 🚿 1 🚗 2



- Semi-Detached Family Home
- Three Good Size Bedrooms, One Fitted
- South Facing Rear Garden
- Convenient Location
- Modern Fitted Open Plan Kitchen/Dining/Lounge
- Driveway Parking To Front
- Cul-De-Sac Location
- EPC Rating - D

If you are looking for a superb family home with a wow factor kitchen then look no further! A beautifully presented, extended, three bedroom, semi-detached family home nestled in this small cul-de-sac in Royton. Accommodation comprising: entrance porch, lounge, superb kitchen/dining/lounge and cloakroom/w.c. and to the first floor three good size bedrooms and a family bathroom. Externally a lovely rear garden and driveway parking to the front.

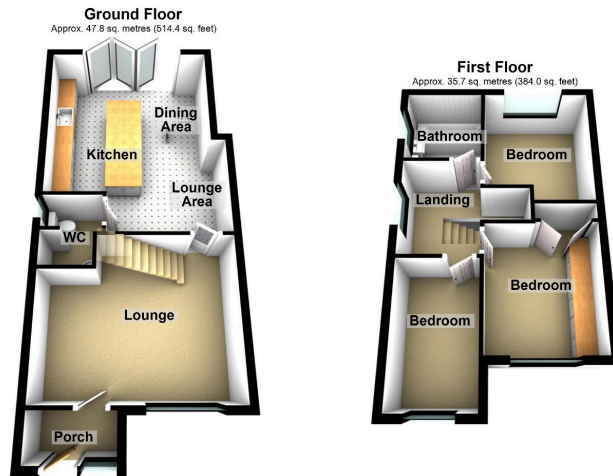

Total area: approx. 83.5 sq. metres (898.4 sq. feet)

Score	Energy rating	Current	Potential
92+	A		
81-91	B		86 B
69-80	C		
55-68	D	61 D	
39-54	E		
21-38	F		
1-20	G		

Royton Office
64 Rochdale Road,
Royton, Oldham,
OL2 6QJ

Monday – Friday. 9am – 5pm
Saturday. 10am – 3 pm
royton@kirkham-property.co.uk
t: 0161 626 9789
f: 0161 652 0514

Out of hours telephone service
Monday – Thursday 8:30am – 7pm
Friday – 8:30am – 5pm
Saturday – Sunday 10am – 3pm