

## Ashwood Drive, Royton, Oldham

£479,950

🛏 3 🚗 2 🚗 2



- Individually Built, Detached, True Bungalow
- Three Bedrooms
- Master Bedroom With En-Suite
- Wrap Around Garden Overlooking Farmland
- Stunning Plot
- Views Over Open Farmland
- Double Garage and Large Sweeping Driveway
- Fitted Kitchen/Breakfast Room
- EPC Rating - D
- Viewing Recommended

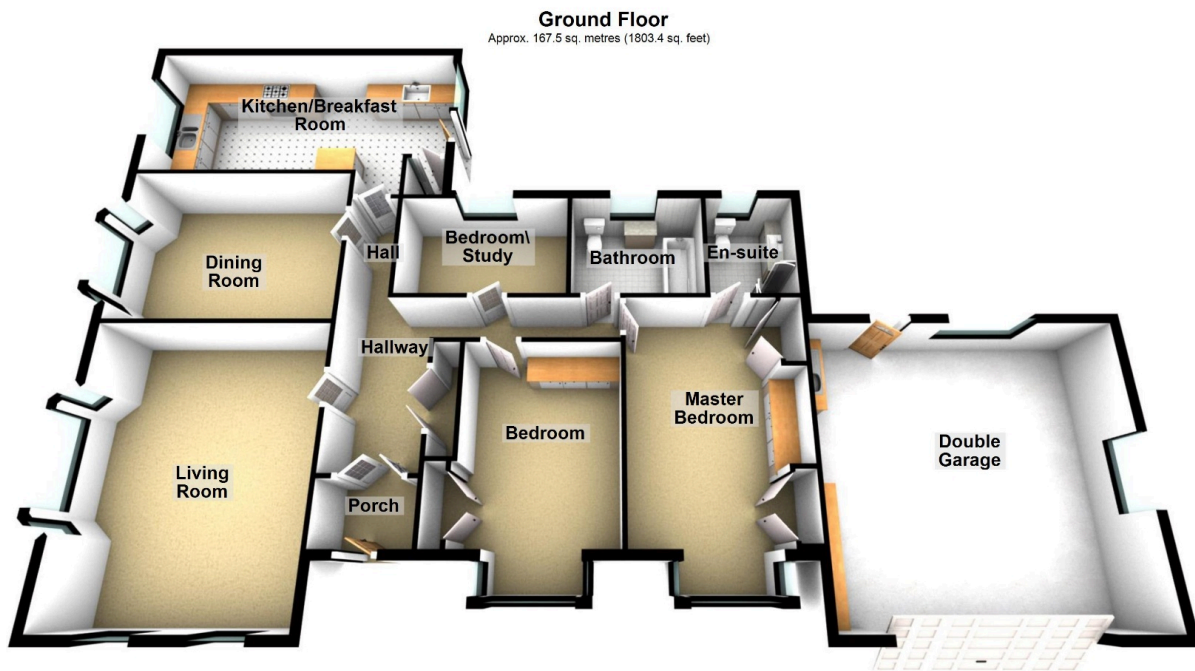

Total area: approx. 167.5 sq. metres (1803.4 sq. feet)

Stunning Plot. Positioned in this secluded location is this privately commissioned three bedroom, detached, true bungalow built circa.1989 and is offered for sale with no chain. The property has a light and airy feel throughout with beautiful views over open farmland make this property a true one off. Accommodation internally comprises of: entrance porch, hallway, dual aspect lounge, dining room, kitchen/breakfast room, master bedroom with en-suite shower room, two further bedrooms and a family bathroom. Externally a wrap around garden, large double garage and plenty of off road parking. This lovely home is located at the base of Ashwood Drive accessed via a private road/driveway.