



Duchess Street, Shaw, Oldham

£239,950

3 1 2



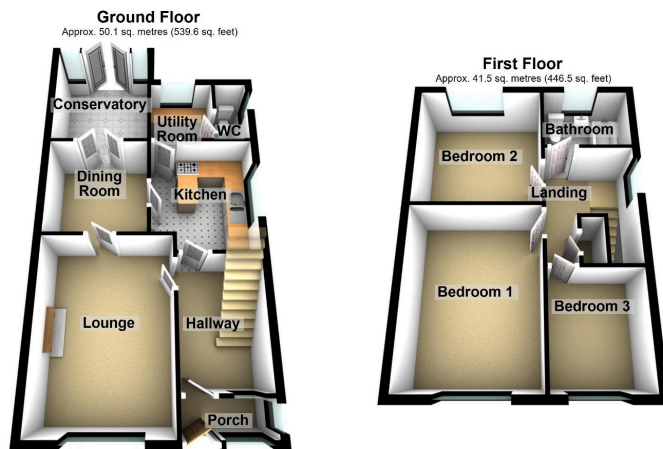

Total area: approx. 91.6 sq. metres (986.1 sq. feet)



A superbly presented, three bedroom, semi-detached family home located in this popular spot within close proximity to St Mary's C of E primary school and Crompton House Voluntary Aided High School. Accommodation internally comprises of: entrance porch, hallway, lounge, dining room, conservatory, kitchen, utility room, cloakroom/w.c., three good size bedrooms and a bathroom. Externally a South Facing garden and a driveway providing off road parking for four cars.

Score	Energy rating	Current	Potential
92+	A		
81-91	B		83 B
69-80	C		
55-68	D	68 D	
39-54	E		
21-38	F		
1-20	G		

Royton Office
64 Rochdale Road,
Royton, Oldham,
OL2 6QJ

Monday – Friday. 9am – 5pm
Saturday. 10am – 3 pm
royton@kirkham-property.co.uk
t: 0161 626 9789
f: 0161 652 0514

Out of hours telephone service
Monday – Thursday 8:30am – 7pm
Friday – 8:30am – 5pm
Saturday – Sunday 10am – 3pm

www.kirkham-property.co.uk