



7 Alderman Close, Greenfield, Saddleworth

£475,000

🛏️ 4 🚿 4 🛋️ 1



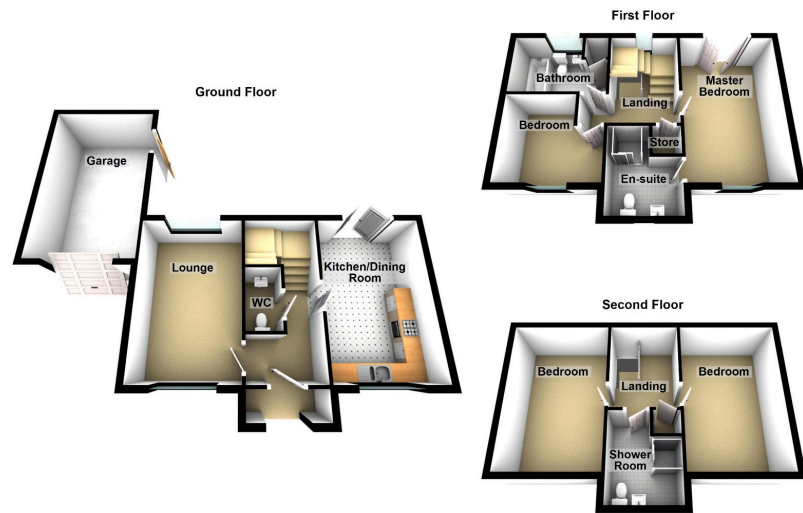

Tucked away in the corner of this brand new executive development is this four bedroom detached house on Alderman Close. This development is in the heart of Greenfield Village and has access to everyday amenities on your doorstep. There are excellent primary schools in walking distance, a brand new secondary school in nearby Diggle Village and countryside walking routes available at Dovestones.

Uppermill Office

35 High Street
Uppermill,
Saddleworth
OL3 6HS

Monday – Friday. 9am – 5pm
Saturday. 10am – 3 pm
uppermill@kirkham-property.co.uk
t: 01457 810 076
f: 01457 810 222

Out of hours telephone service
Monday – Thursday 8:30am – 7pm
Friday – 8:30am – 5pm
Saturday – Sunday 10am – 3pm