



5 Alderman Close, Greenfield, Saddleworth

£430,000

4 3 1



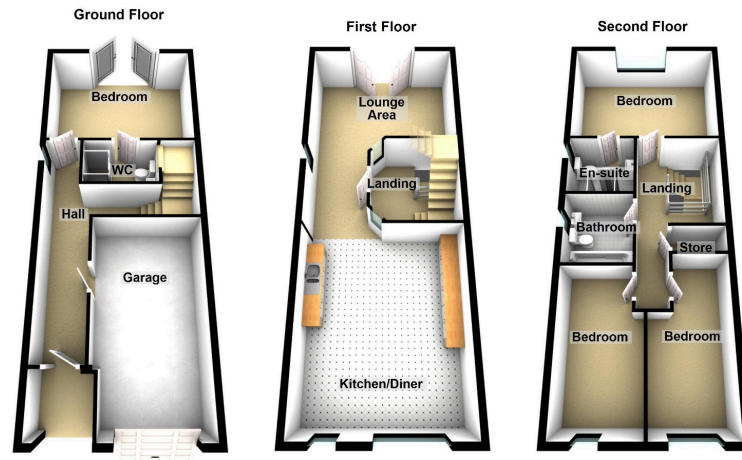

Kirkham Property are extremely pleased to market the brand new development in Greenfield built by a well regarded local developer. This four bedroom semi detached house is in the heart of Greenfield and is made up of just ten executive properties and is a highly sought after development. There are just three styles of property on the development. This four bedroom semi detached house is over three floors and offers modern open plan kitchen/living/dining to the first floor.



Uppermill Office

35 High Street
Uppermill,
Saddleworth
OL3 6HS

Monday – Friday. 9am – 5pm
Saturday. 10am – 3 pm
uppermill@kirkham-property.co.uk
t: 01457 810 076
f: 01457 810 222

Out of hours telephone service
Monday – Thursday 8:30am – 7pm
Friday – 8:30am – 5pm
Saturday – Sunday 10am – 3pm