



2 Alderman Close, Greenfield, Saddleworth

£330,000

🛏️ 2 🪑 2 🚗 1



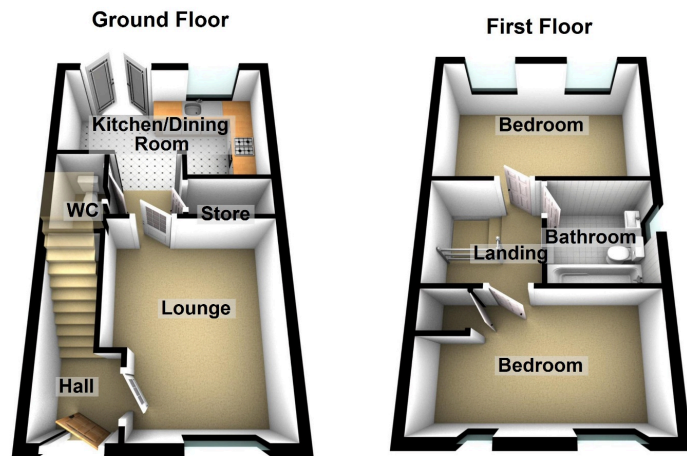

Kirkham Property are thrilled to present a brand new highly sought after development in central Greenfield. Alderman Close is acul de sac of just ten properties located in the heart of Greenfield Village within walking distance of the train station. This two bedroom semi detached house is one of three styles of property built on this development. A high specification awaits the prospective buyer with KutchenHaus fitted kitchens, integrated Bosch & Neff appliances and modern bathroom suites.



Uppermill Office

35 High Street
Uppermill,
Saddleworth
OL3 6HS

Monday – Friday. 9am – 5pm
Saturday. 10am – 3 pm
uppermill@kirkham-property.co.uk
t: 01457 810 076
f: 01457 810 222

Out of hours telephone service
Monday – Thursday 8:30am – 7pm
Friday – 8:30am – 5pm
Saturday – Sunday 10am – 3pm