

## Cornish Way, Royton, Oldham

Offers Over £190,000

🛏 3 🚿 1 🚗 2



- Semi-Detached Family Home
- Three Bedrooms
- Gardens To Front & Rear
- uPVC Double Glazing & Gas Central Heating
- 
- No Chain
- Driveway & Garage
- Close To Local Amenities
- EPC Rating -
-

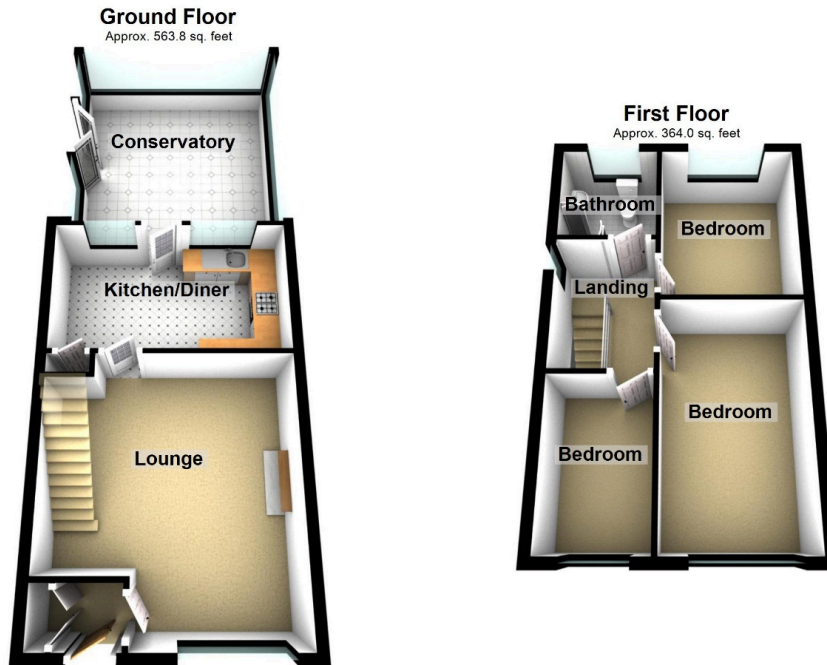

Total area: approx. 927.8 sq. feet

Offered for sale with No Chain is this three bedroom, semi-detached, family home located in this popular development with local primary and secondary schools within a stones throw. Accommodation internally comprises of: entrance hallway, lounge, kitchen/diner, large conservatory, three bedrooms and a shower room. Externally a small flagged rear garden, detached garage and driveway parking.