

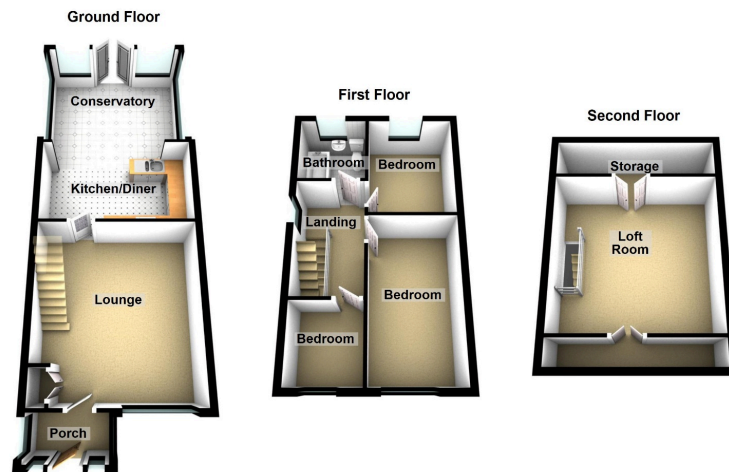

Park Crescent, Chadderton
£179,950

3 1 1





Situated within the highly regarded area of North Chadderton and with fabulous far reaching views is this three bedroom semi detached house which is offered with vacant possession. The property briefly comprises entrance porch, lounge, kitchen/diner and conservatory, whilst to the first floor there are three bedrooms and a family bathroom, to the second floor there is a good sized loft room with eaves storage. There are garden to the front, side and rear. In a quiet cul-de-sac location with lovely views and only walking distance to St Mathews primary school, Chadderton Hall junior school and North Chadderton secondary school. Mills Hill train station and Westwood tram station are a short distance away as are the M60 + M62 motorway connections. Parking is provided by way of a garage in a block situated close to the property. Access to the house is via steps to the front.

Score	Energy rating	Current	Potential
92+	A		
81-91	B		
69-80	C		72 C
55-68	D		
39-54	E	52 E	
21-38	F		
1-20	G		

Chadderton Office

509 Middleton Road,
Chadderton, Oldham,
OL9 9SH

Monday – Friday. 9am – 5pm

Saturday. 10am – 3 pm
chadderton@kirkham-property.co.uk

t: 0161 626 5688

f: 0161 628 0350

Out of hours telephone service

Monday – Thursday 8:30am – 7pm

Friday – 8:30am – 5pm

Saturday – Sunday 10am – 3pm