

## Rochdale Road, Royton, Oldham

£175,000

🛏️ 2 🚿 1 🚗 2



- Character, Mid Terraced Property
- Two Bedrooms
- Modern Fitted Kitchen
- Superb Four Piece Bathroom
- Close To Royton Centre
- uPVC Double Glazing & Gas Central Heating
- Useful Cellar Room
- EPC Rating -
- 
-

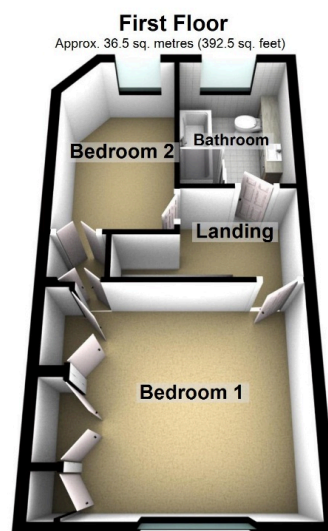
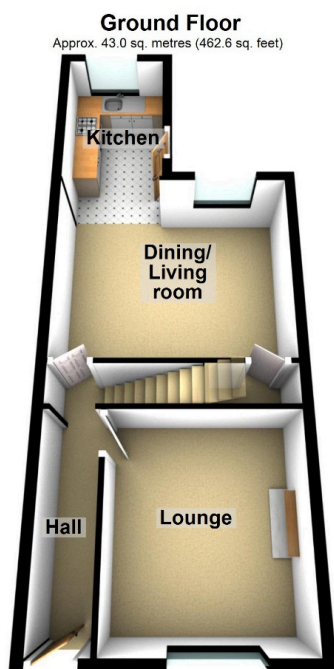

Total area: approx. 79.4 sq. metres (855.1 sq. feet)

A lovely, two bedroom, character, terraced property located within a short walk of Tandle Hill Country Park. Accommodation briefly comprising of: entrance hallway, lounge, dining room/living room and kitchen to the ground floor and to the first floor two bedrooms and a superb four piece bathroom. Beautiful views over open farmland to the rear, a decked courtyard and on road parking.