

Highfield Drive, Royton, Oldham

£385,000

 4  2  3



- Four Bedroom, Detached, Family Home
- Master Bedroom En-Suite
- Conservatory
- Garage, Driveway & Gardens
- Beautifully Presented Throughout
- Lounge & Dining Room
- Modern Fitted Kitchen/Breakfast Room
- EPC Rating - B

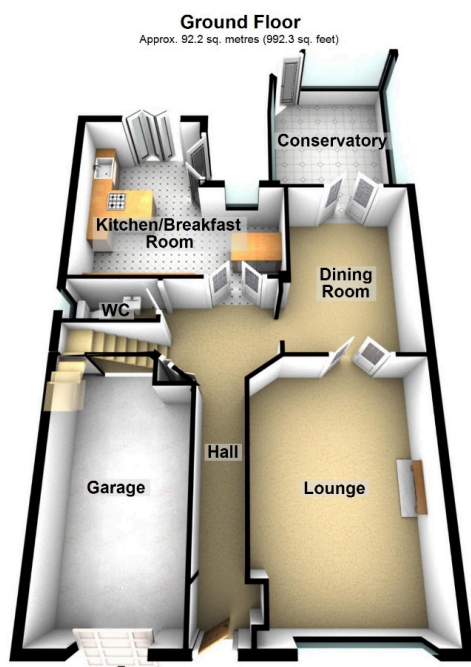

Total area: approx. 159.9 sq. metres (1721.3 sq. feet)

Built by McClean Homes is this beautifully presented 'Windsor' design home offering superb family accommodation. Briefly comprising of: entrance hallway, cloakroom/w.c., lounge, dining room, conservatory, kitchen with Bi-fold doors and internal garage access to the ground floor and to the first floor master bedroom with en-suite, three further bedrooms and a lovely family bathroom. Externally a large block paved driveway providing off road parking for four cars and a rear garden with lawn. The property is positioned in a cul-de-sac with easy access to all motorway networks.