

Martindale Close, Royton, Oldham

£314,950

3 1 1



- Detached Family Home
- Beautifully Presented Throughout
- Popular & Convenient Location
- Enclosed Rear Garden
- Three Bedrooms
- Modern Fitted Kitchen/Dining Room
- Off Road Parking
- EPC Rating -

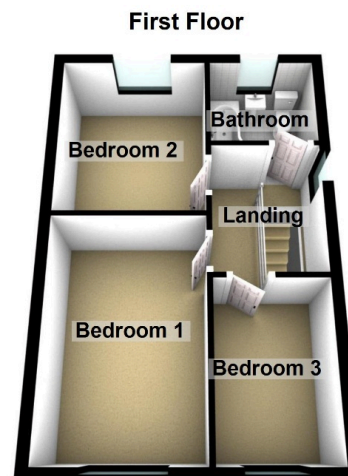

A beautifully, extended, three bedroom, detached family home located in this small cul-de-sac in Royton. This superb property boasts an amazing handless kitchen, living room, lounge, cloakroom/w.c and utility room to the ground floor and to the first floor three bedrooms and a lovely bathroom. Externally a West facing garden and driveway parking. Call us to arrange a viewing, you won't be disappointed.