



The Ridgedales, Coleridge Road, Oldham

Offers Over £89,995

🛏️ 2 🚿 1 🚪 1



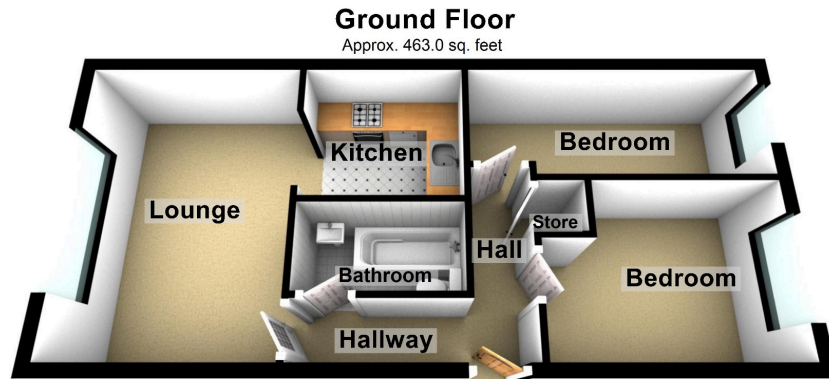

Total area: approx. 463.0 sq. feet



No Chain - Located in Moorside just off Ripponden Road in the cusp of Saddleworth is this well presented, two bedroom, first floor apartment. Tucked away in a secluded position with the added benefit of an allocated parking space to the front. Accommodation briefly comprises of: entrance with secure intercom entry system, private door, hallway, lounge, kitchen, two bedrooms and a bathroom. Externally there are communal grounds and an allocated parking space. Local shops, amenities and public transport links are within easy reach.

Score	Energy rating	Current	Potential
92+	A		
81-91	B		
69-80	C		73 C
55-68	D	65 D	
39-54	E		
21-38	F		
1-20	G		

Chadderton Office

509 Middleton Road,
Chadderton, Oldham,
OL9 9SH

Monday – Friday. 9am – 5pm
Saturday. 10am – 3 pm
chadderton@kirkham-property.co.uk
t: 0161 626 5688
f: 0161 628 0350

Out of hours telephone service
Monday – Thursday 8:30am – 7pm
Friday – 8:30am – 5pm
Saturday – Sunday 10am – 3pm