



The Cottages, Heathfields, Uppermill

£450,000



ALL. TOGETHER. BETTER.

www.kirkham-property.co.uk

The Cottages, Heathfields, Uppermill

Situated on a small hamlet and within walking distance of Uppermill High Street is this four double bedroom semi detached house on Heathfields. This is a stone built house with character features including exposed stonework, beams and a wood burning fire in the lounge. The property is located at the end of a private road of just five properties and has a pleasing outlook backing onto a nearby stream. The home is well positioned being a short walk to all village amenities in Uppermill as well as having well regarded schools on your doorstep. In addition to this, just a short journey away are excellent countryside walking routes including Dovestones Reservoir and the Delph Donkey walking trail. Greenfield railway station is accessible and provides regular services to Manchester and Leeds.











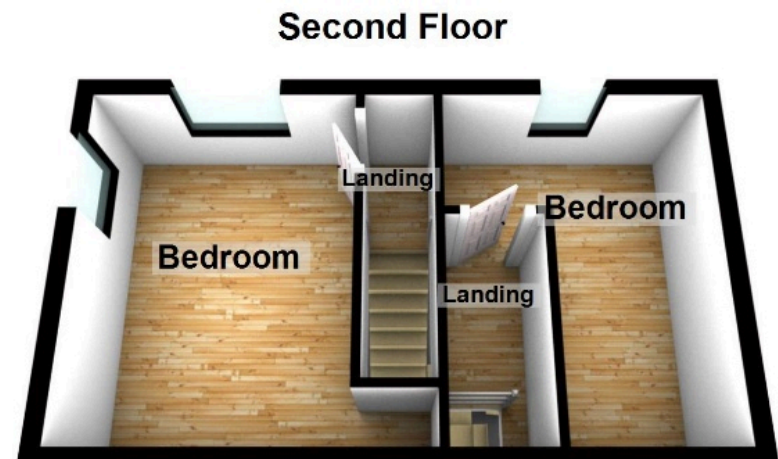
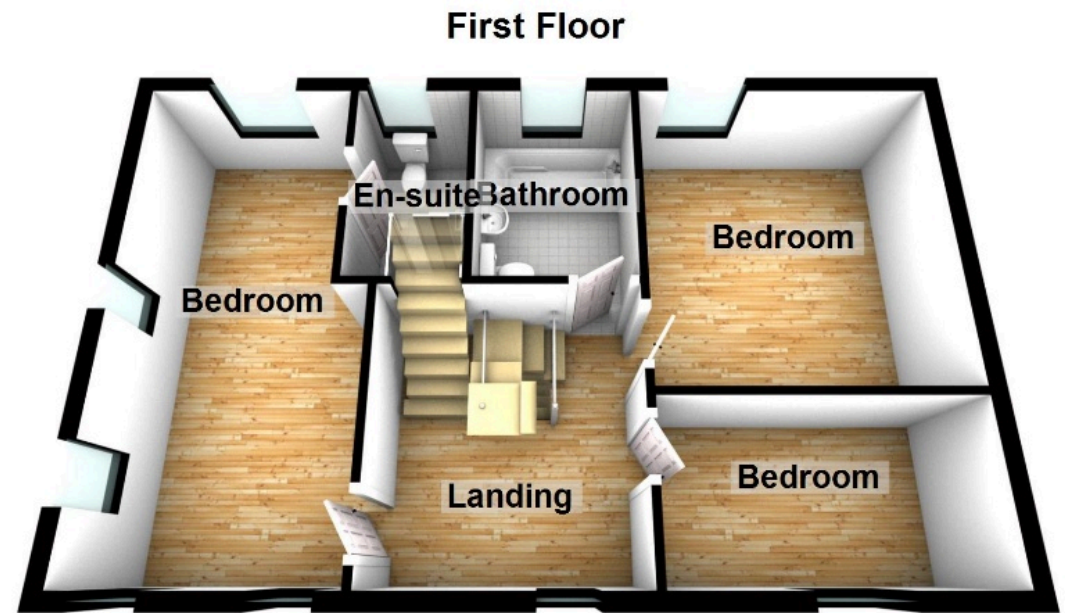
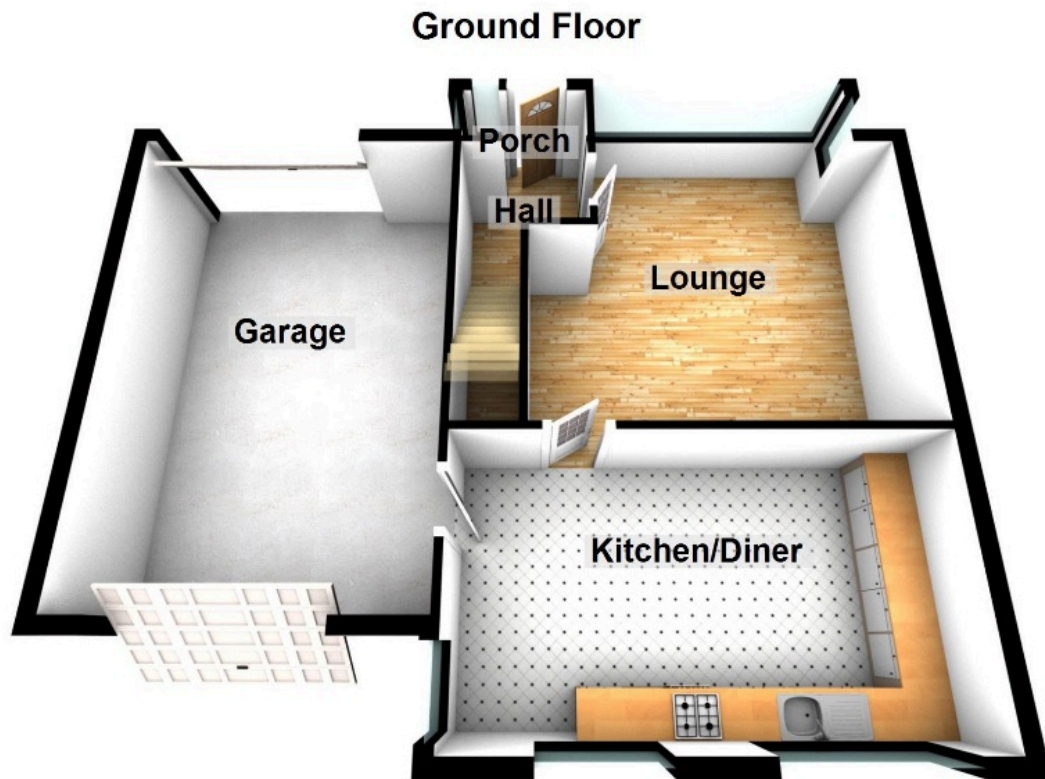

Uppermill Office

35 High Street
Uppermill,
Saddleworth
OL3 6HS

Monday – Friday. 9am – 5pm
Saturday. 10am – 3 pm
uppermill@kirkham-property.co.uk
t: 01457 810 076
f: 01457 810 222

Out of hours telephone service
Monday – Thursday 8:30am – 7pm
Friday – 8:30am – 5pm
Saturday – Sunday 10am – 3pm